

View 1

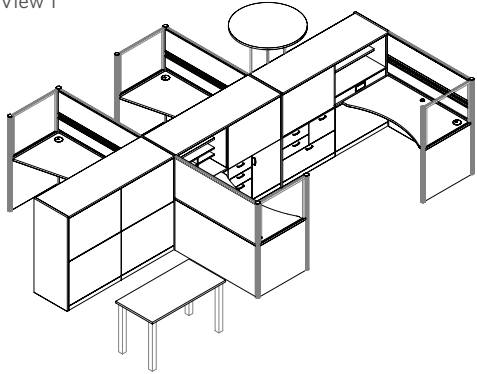

View 2

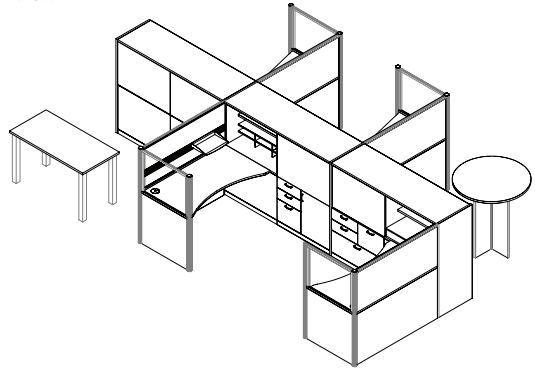

View 3

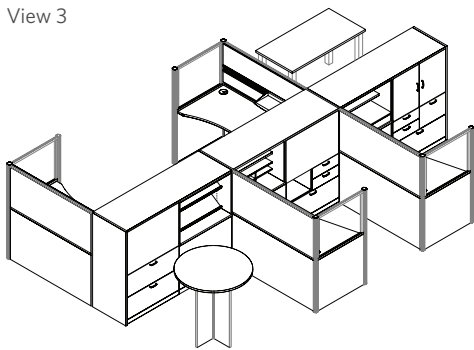

View 4

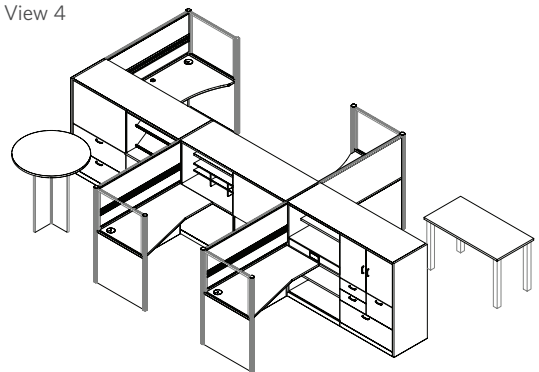

NeoCon 2008 / WORKSTATIONS - Component Summary*

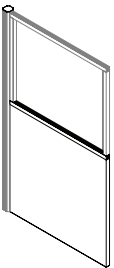

Three panel Privacy
Qty: 4 30" w x 54" h
25" h Aluminum framed
clear safety glass top
panel.

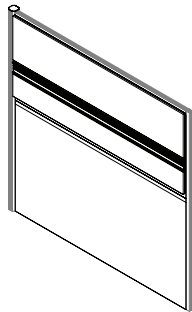

Two panel Privacy
Qty: 4 54" w x 54" h
- 25" h laminate upper panel
- surface mounted tackboard/
accessory rail, one side

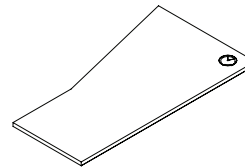

Galley Shape Desk
Qty: 2 54" w x 30/21" d
- Panel/storage mounted
- shown with option grommet
- 3mm PVC trim

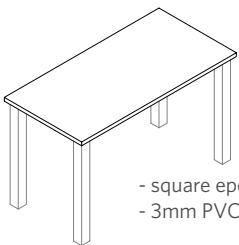

Free standing table
Qty: 1 48" w x 24" d
- square epoxy coated metal legs
- 3mm PVC trim

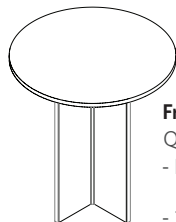

Freestanding round table
Qty: 1 36" w x 40" h
- laminate Cross base with
aluminum accents
- 3mm PVC trim

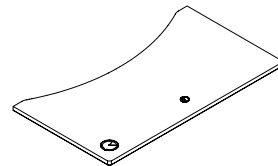

Saddle Shape Desk
Qty: 2 54" w x 30" d
- Panel/storage mounted
- shown with option grommet
- 3mm PVC trim

NeoCon 2008 / WORKSTATIONS - Component Summary continued

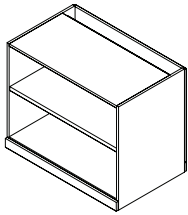

G1 Base cabinet
 Qty: 1 35" w x 29" h x 22" d
 - Open with adjustable shelf
 - integrated cable management

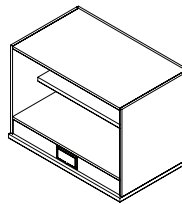

G1 Stacking cabinet
 Qty: 2 35" w x 25" h x 22" d
 - Open with one recessed adjustable shelf
 - Shown with option Recessed power shelf - RPDSL-35 includes two receptacles, voice and data inserts
 - one unit has laminate back
 - one unit has whiteboard back

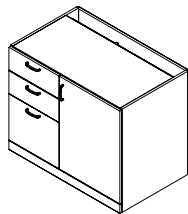

A4F2 Base cabinet
 Qty: 1 35" w x 29" h x 22" d
 - Box/Box/File - right side door
 - locking drawers
 - integrated cable management

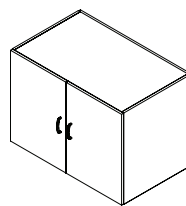

F7 Stacking cabinet
 Qty: 1 35" w x 25" h x 22" d
 - two doors
 - one full depth adjustable shelf
 - laminate back

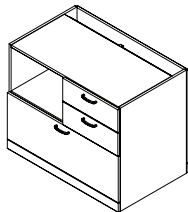

A0 Base cabinet
 Qty: 1 35" w x 29" h x 22" d
 - Open left/Box/Box/Lateral File
 - locking drawers
 - integrated cable management

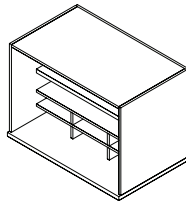

G1 Stacking cabinet
 Qty: 2 35" w x 25" h x 22" d
 - Open with one recessed adjustable shelf
 - Shown with two option shelf organizers, SLDIV-3514
 - includes two optional organizer drawers to fit shelf organizers (not shown)
 - laminate back

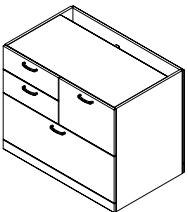

A8 Base cabinet
 Qty: 2 35" w x 29" h x 22" d
 - Box/Box/File/Lateral File
 - locking drawers
 - integrated cable management

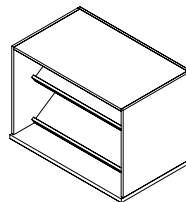

V2 Stacking cabinet
 Qty: 1 35" w x 25" h x 22" d
 - two slanted display shelves
 - shelves pivot for access to recessed shelf and base
 - laminate back

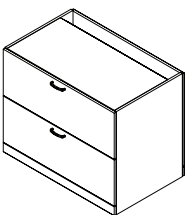

A2 Base cabinet
 Qty: 1 35" w x 29" h x 22" d
 - 2 drawer lateral file with lock
 - integrated cable management

Included Items not shown:
 - two vertical laminate end panels
 - two vertical laminate central panels for privacy panel connection
 - three 1" laminate tops

TYPICALS

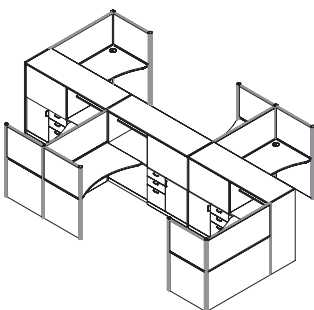

Quote #: 209755*
 \$2412 per station x 6

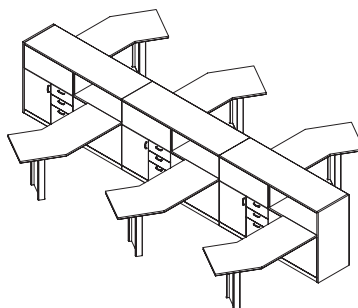

Quote #: 209756*
 \$1577 per station x 6

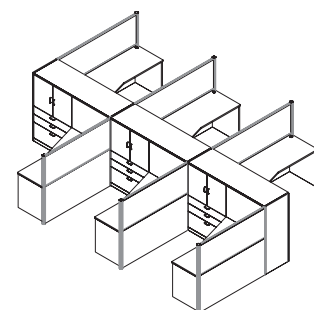

Quote #: 209757*
 \$2388 per station x 6

